

Altum Linear Light



SU-AL-VAR-XX-V2

Warnings

- 1. Only qualified electricians should install this luminaire. All electrical and grounded connections MUST be in accordance with National Electrical Code and the Canadian Electrical Code, and any applicable local code requirements.
- 2. In case of smoke, or spark emerging from the wire , please turn off the power supply to the wire immediately and notify the relevant personnel.
- 3. Minimum 90°C Supply Conductor Requirement.
- 4. Do not expose this fixture to direct water. This fixture is not waterproof and is ONLY suitable for damp locations.
- 5. Please do not stare directly at the LED Lights, and wear gloves before installing the fixture to avoid an injury.
- 6. Please inspect the fixture for probable damages (arising from shipment) before installing and contact ARANI immediately.
- 7. Please confirm all accessories are included in the box and read the installation instructions carefully prior to installing the fixture.
- 8. This fixture is designed to operate in ambient temperatures ranging from -40° to 50°C. Using it in temperatures outside this range will reduce its lifespan.
- 9. Switch OFF the main power supply (at the fuse/ circuit breaker) before wiring-in the fixture.
- 10. Please clean the luminaire regularly to ensure maintenance and its longevity.

| SKU | Colour | Input Voltage | Rated Power (Selectable) | CCT (Selectable) | Courant nominal |
|-----------------|--------|---------------|--------------------------|-----------------------|-----------------|
| SU-AL-VAR-SL-V2 | Silver | 120-347Vac | 28W 34W 42W | 3000K 4000K 5000K | 0.5A |
| SU-AL-VAR-BK-V2 | Black | | | | |
| SU-AL-VAR-WH-V2 | White | | | | |

Dimensions

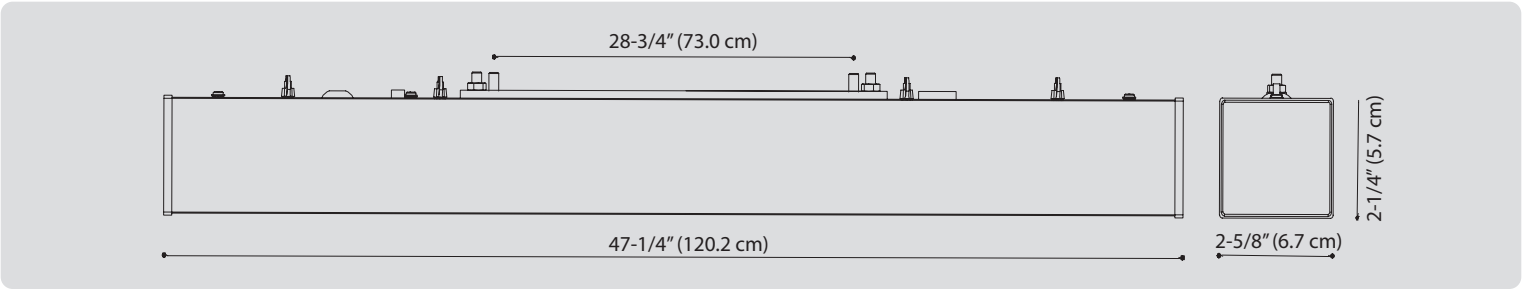

Accessories included



Ceiling mount parts

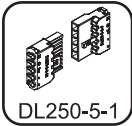

Connector



Straight jointer



Long Jointer

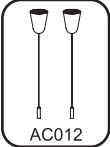

Adjustable hanging system



ETL round canopy with 5 feet power cable

Additional Accessories

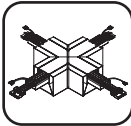

Cross jointer
SU-AL-VAR-XX-C-X

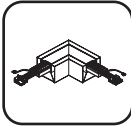

90° jointer
SU-AL-VAR-XX-C-L

B Suspended installation (AC012)

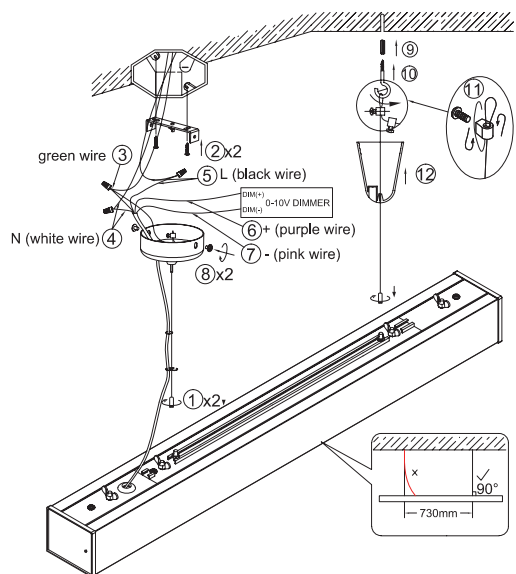

C Straight link (AC042) I

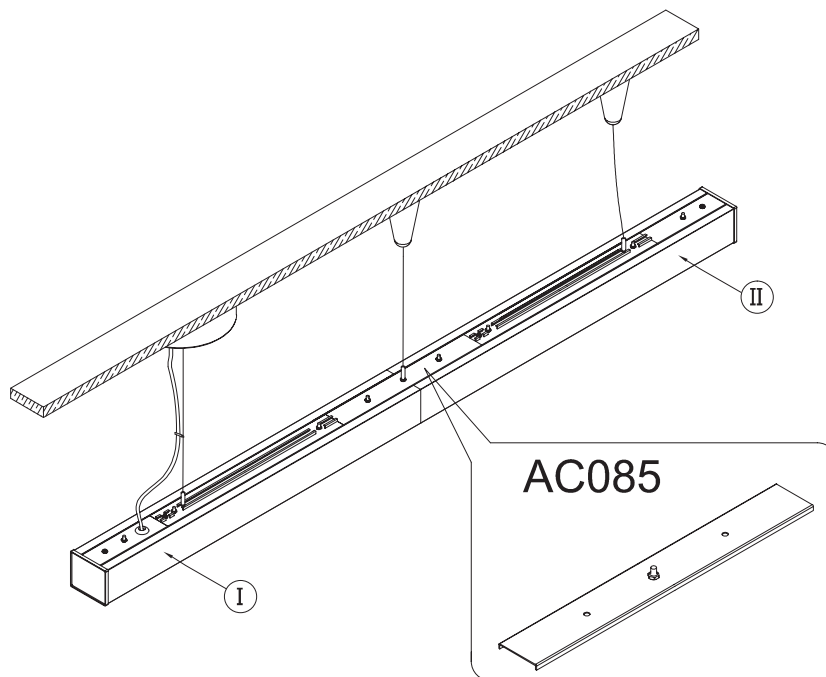
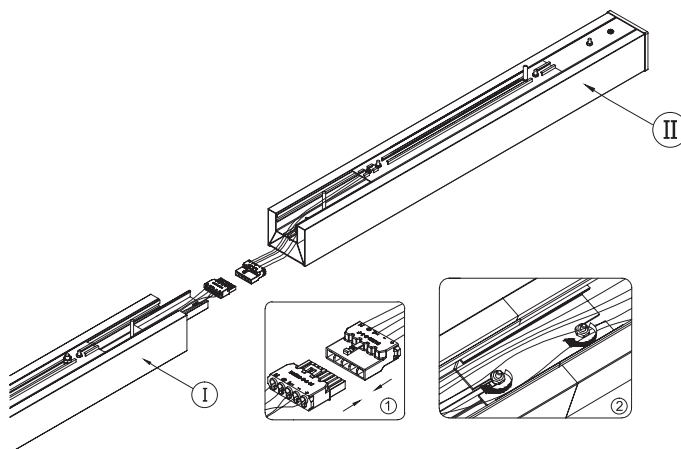
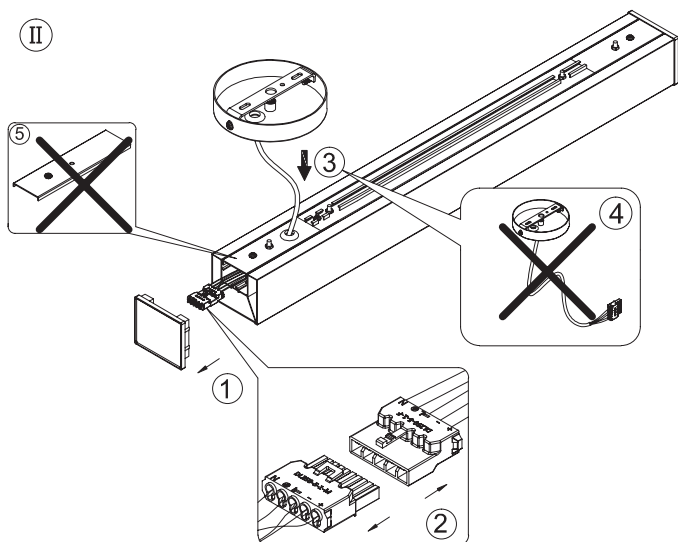
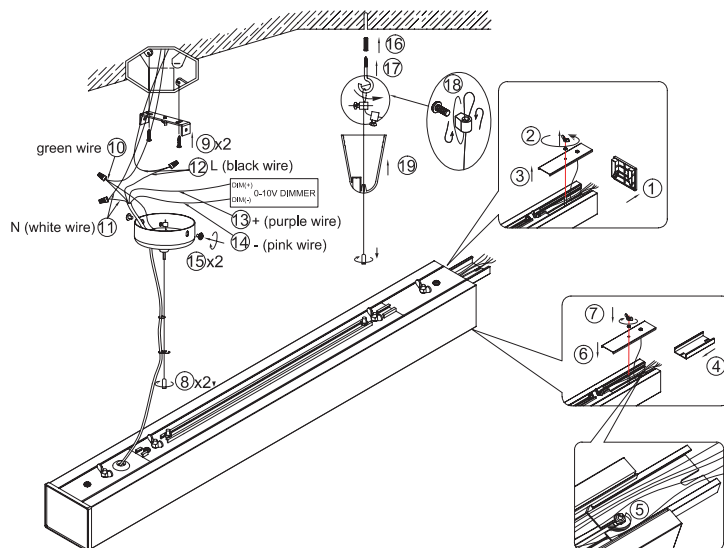

④ 90 degree link

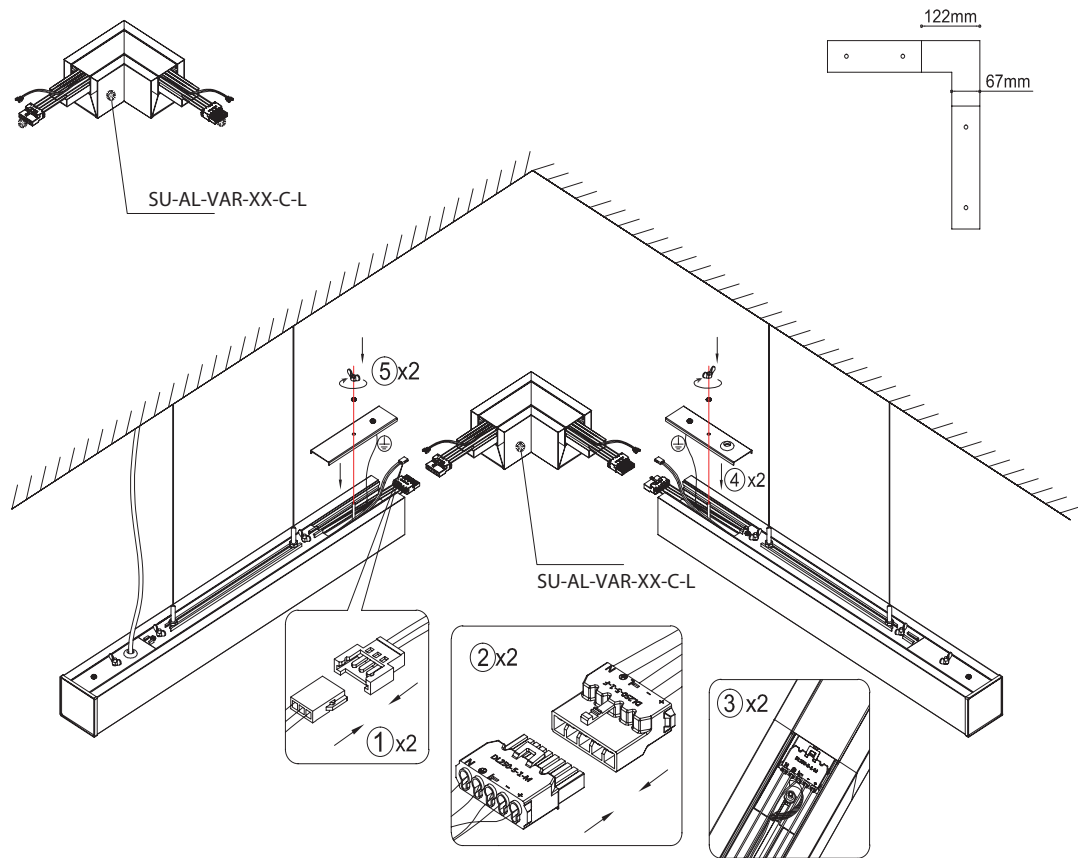

⑤ Cross link

